



Today's Theme



AI (Artificial Intelligence)

Q AI (Artificial Intelligence), the hottest topic! In what area is it expected to be used? (Part-2)

A It is expected that development of E-commerce will lead AI related industry to grow in Wholesale and Retail Trade sector. Its current market size based on revenue (about JPY 1.5 trillion as of 2015) is likely to grow more than 10 times to approx. JPY 15.2 trillion in 2030!

- It is likely that people can shop without paying by cash or even electronic money based on the personal data previously registered with the development of Biometric technology. Meanwhile, for corporates, (i) sales growth can be expected by using sales data to operate shops (display and order of merchandize) and (ii) optimal personnel allocation will become possible by work shift management reflecting influence of weather and holidays in future.
- Regarding online shopping sites, provision of most suitable advertisement to each user based on its browsing behavior is in place. Nowadays, online shoppers can purchase merchandizes as if consulting with store staffs anytime and anywhere by using AI's conversation function such as voice chat system.

“Image of how AI will be used in commercial field”

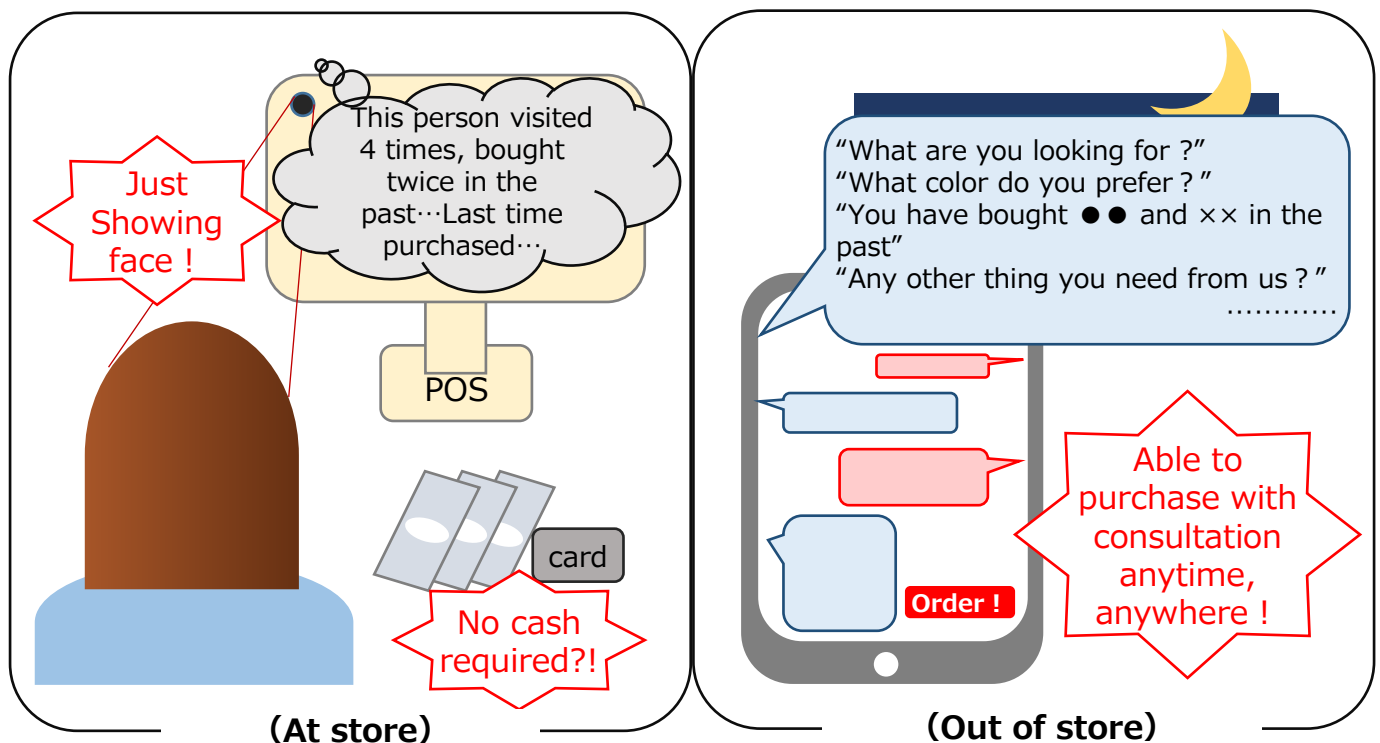



Disclaimer

Please read this disclaimer carefully.

- This material is for non-Japanese institutional investors only.
- The research and analysis included in this report, and those opinions or judgments as outcomes thereof, are intended to introduce or demonstrate capabilities and expertise of Sumitomo Mitsui Asset Management Company, Ltd. (hereinafter “SMAM”), or to provide information on investment strategies and opportunities. Therefore this material is not intended to offer or solicit investments, provide investment advice or service, or to be considered as disclosure documents under the Financial Instruments and Exchange Law of Japan.
- The expected returns or risks in this report are calculated based upon historical data and/or estimated upon the economic outlook at present, and should be construed no warrant of future returns and risks.
- Past performance is not necessarily indicative of future results.
- The simulated data or returns in this report besides the fund historical returns do not include/reflect any investment management fees, transaction costs, or re-balancing costs, etc.
- The investment products or strategies do not guarantee future results nor guarantee the principal of investments. The investments may suffer losses and the results of investments, including such losses, belong to the client.
- The recipient of this report must make its own independent decisions regarding investments.
- The opinions, outlooks and estimates in this report do not guarantee future trends or results. They constitute SMAM's judgment as of the date of this material and are subject to change without notice.
- The awards included in this report are based on past achievements and do not guarantee future results.
- The intellectual property and all rights of the benchmarks/indices belong to the publisher and the authorized entities/individuals.
- This material has been prepared by obtaining data from sources which are believed to be reliable but SMAM can not and does not guarantee its completeness or accuracy.
- All rights, titles and interests in this material and any content contained herein are the exclusive properties of SMAM, except as otherwise stated. It is strictly prohibited from using this material for investments, reproducing/copying this material without SMAM's authorization, or from disclosing this material to a third party.

Registered Number: Kanto Local Finance Bureau (KINSHO) No.399

Member of Japan Investment Advisers Association, The Investment Trusts Association, Japan and

Type II Financial Instruments Firms Association

© Sumitomo Mitsui Asset Management Company, Limited